

Seller disclosure statement



Queensland
Government

Property Law Act 2023 section 99

Form 2, Version 1 | Effective from: 1 August 2025

WARNING TO BUYER – This statement contains important legal and other information about the property offered for sale. You should read and satisfy yourself of the information in this statement before signing a contract. You are advised to seek legal advice before signing this form. You should not assume you can terminate the contract after signing if you are not satisfied with the information in this statement.

WARNING – You must be given this statement before you sign the contract for the sale of the property.

This statement does not include information about:

- » flooding or other natural hazard history
- » structural soundness of the building or pest infestation
- » current or historical use of the property
- » current or past building or development approvals for the property
- » limits imposed by planning laws on the use of the land
- » services that are or may be connected to the property
- » the presence of asbestos within buildings or improvements on the property.

You are encouraged to make your own inquiries about these matters before signing a contract. You may not be able to terminate the contract if these matters are discovered after you sign.

Part 1 – Seller and property details

Seller **Robert Derek Morris**

Property address
(referred to as the
"property" in this
statement)

2 MIKADO STREET, HAMILTON QLD 4007

Lot on plan description

2/RP100681

Community titles scheme
or BUGTA scheme:

Is the property part of a community titles scheme or a BUGTA scheme:

Yes

No

*If Yes, refer to Part 6 of this statement
for additional information*

*If No, please disregard Part 6 of this statement
as it does not need to be completed*

Part 2 – Title details, encumbrances and residential tenancy or rooming accommodation agreement

Title details

The seller gives or has given the buyer the following—

A title search for the property issued under the *Land Title Act 1994* showing interests registered under that Act for the property.

Yes

A copy of the plan of survey registered for the property.

Yes

Registered encumbrances

Registered encumbrances, if any, are recorded on the title search, and may affect your use of the property. Examples include easements, statutory covenants, leases and mortgages.

You should seek legal advice about your rights and obligations before signing the contract.

Unregistered encumbrances (excluding statutory encumbrances)

There are encumbrances not registered on the title that will continue **Yes** **No** to affect the property after **settlement**.

Note—If the property is part of a community titles scheme or a BUGTA scheme it may be subject to and have the benefit of statutory easements that are **NOT** required to be disclosed.

Unregistered lease (if applicable)

If the unregistered encumbrance is an unregistered lease, the details of the agreement are as follows:

- » the start and end day of the term of the lease:
- » the amount of rent and bond payable:
- » whether the lease has an option to renew:

Other unregistered agreement in writing (if applicable)

If the unregistered encumbrance is created by an agreement in writing, and is not an unregistered lease, a copy of the agreement is given, together with relevant plans, if any. **Yes**

Unregistered oral agreement (if applicable)

If the unregistered encumbrance is created by an oral agreement, and is not an unregistered lease, the details of the agreement are as follows:

Statutory encumbrances

There are statutory encumbrances that affect the property. **Yes** **No**

If Yes, the details of any statutory encumbrances are as follows:

Energex Assets, Infrastructure owned by Queensland Urban Utilities, Fibre optic and/or major network owned by Telstra, NBN Communication Assets, Brisbane City Council stormwater network assets and APA Gas Pipeline and Gas Assets, all as shown and described on the attached plans

Residential tenancy or rooming accommodation agreement

The property has been subject to a residential tenancy agreement or a rooming accommodation agreement under the *Residential Tenancies and Rooming Accommodation Act 2008* during the last 12 months. **Yes** **No**

If **Yes**, when was the rent for the premises or each of the residents' rooms last increased? (*Insert date of the most recent rent increase for the premises or rooms*)

Note—Under the *Residential Tenancies and Rooming Accommodation Act 2008* the rent for a residential premises may not be increased earlier than 12 months after the last rent increase for the premises.

As the owner of the property, you may need to provide evidence of the day of the last rent increase. You should ask the seller to provide this evidence to you prior to settlement.

Part 3 – Land use, planning and environment

WARNING TO BUYER – You may not have any rights if the current or proposed use of the property is not lawful under the local planning scheme. You can obtain further information about any planning and development restrictions applicable to the lot, including in relation to short-term letting, from the relevant local government.

Zoning	The zoning of the property is <i>(Insert zoning under the planning scheme, the Economic Development Act 2012; the Integrated Resort Development Act 1987; the Mixed Use Development Act 1993; the State Development and Public Works Organisation Act 1971 or the Sanctuary Cove Resort Act 1985, as applicable)</i> : <div style="border: 1px solid black; padding: 5px; width: fit-content;">CR1 Character (Character)</div>	
Transport proposals and resumptions	The lot is affected by a notice issued by a Commonwealth, State or local government entity and given to the seller about a transport infrastructure proposal* to: locate transport infrastructure on the property; or alter the dimensions of the property.	<input type="checkbox"/> Yes <input checked="" type="checkbox"/> No
	The lot is affected by a notice of intention to resume the property or any part of the property.	<input type="checkbox"/> Yes <input checked="" type="checkbox"/> No
	<i>If Yes, a copy of the notice, order, proposal or correspondence must be given by the seller.</i>	
* <i>Transport infrastructure</i> has the meaning defined in the <i>Transport Infrastructure Act 1994</i> . A <i>proposal</i> means a resolution or adoption by some official process to establish plans or options that will physically affect the property.		
Contamination and environmental protection	The property is recorded on the Environmental Management Register or the Contaminated Land Register under the <i>Environmental Protection Act 1994</i> .	<input type="checkbox"/> Yes <input checked="" type="checkbox"/> No
	The following notices are, or have been, given:	
	A notice under section 408(2) of the <i>Environmental Protection Act 1994</i> (for example, land is contaminated, show cause notice, requirement for site investigation, clean up notice or site management plan).	<input type="checkbox"/> Yes <input checked="" type="checkbox"/> No
	A notice under section 369C(2) of the <i>Environmental Protection Act 1994</i> (the property is a place or business to which an environmental enforcement order applies).	<input type="checkbox"/> Yes <input checked="" type="checkbox"/> No
	A notice under section 347(2) of the <i>Environmental Protection Act 1994</i> (the property is a place or business to which a prescribed transitional environmental program applies).	<input type="checkbox"/> Yes <input checked="" type="checkbox"/> No
Trees	There is a tree order or application under the <i>Neighbourhood Disputes (Dividing Fences and Trees) Act 2011</i> affecting the property. <i>If Yes, a copy of the order or application must be given by the seller.</i>	<input type="checkbox"/> Yes <input checked="" type="checkbox"/> No
Heritage	The property is affected by the <i>Queensland Heritage Act 1992</i> or is included in the World Heritage List under the <i>Environment Protection and Biodiversity Conservation Act 1999</i> (Cwlth).	<input type="checkbox"/> Yes <input checked="" type="checkbox"/> No
Flooding	Information about whether the property is affected by flooding or another natural hazard or within a natural hazard overlay can be obtained from the relevant local government and you should make your own enquires. Flood information for the property may also be available at the FloodCheck Queensland portal or the Australian Flood Risk Information portal.	
Vegetation, habitats and protected plants	Information about vegetation clearing, koala habitats and other restrictions on development of the land that may apply can be obtained from the relevant State government agency.	

Part 4 – Buildings and structures

WARNING TO BUYER – The seller does not warrant the structural soundness of the buildings or improvements on the property, or that the buildings on the property have the required approval, or that there is no pest infestation affecting the property. You should engage a licensed building inspector or an appropriately qualified engineer, builder or pest inspector to inspect the property and provide a report and also undertake searches to determine whether buildings and improvements on the property have the required approvals.

Swimming pool	<p>There is a relevant pool for the property. <input checked="" type="checkbox"/> Yes <input type="checkbox"/> No</p> <p>If a community titles scheme or a BUGTA scheme – a shared pool is located in the scheme. <input type="checkbox"/> Yes <input type="checkbox"/> No</p> <p>Pool compliance certificate is given. <input type="checkbox"/> Yes <input type="checkbox"/> No</p> <p>OR</p> <p>Notice of no pool safety certificate is given. <input checked="" type="checkbox"/> Yes <input type="checkbox"/> No</p>
Unlicensed building work under owner builder permit	<p>Building work was carried out on the property under an owner builder permit in the last 6 years. <input type="checkbox"/> Yes <input checked="" type="checkbox"/> No</p> <p><i>A notice under section 47 of the Queensland Building and Construction Commission Act 1991 must be given by the seller and you may be required to sign the notice and return it to the seller prior to signing the contract.</i></p>
Notices and orders	<p>There is an unsatisfied show cause notice or enforcement notice under the <i>Building Act 1975</i>, section 246AG, 247 or 248 or under the <i>Planning Act 2016</i>, section 167 or 168. <input type="checkbox"/> Yes <input checked="" type="checkbox"/> No</p> <p>The seller has been given a notice or order, that remains in effect, from a local, State or Commonwealth government, a court or tribunal, or other competent authority, requiring work to be done or money to be spent in relation to the property. <input type="checkbox"/> Yes <input checked="" type="checkbox"/> No</p> <p><i>If Yes, a copy of the notice or order must be given by the seller.</i></p>
Building Energy Efficiency Certificate	<p>If the property is a commercial office building of more than 1,000m², a Building Energy Efficiency Certificate is available on the Building Energy Efficiency Register.</p>
Asbestos	<p>The seller does not warrant whether asbestos is present within buildings or improvements on the property. Buildings or improvements built before 1990 may contain asbestos. Asbestos containing materials (ACM) may have been used up until the early 2000s. Asbestos or ACM may become dangerous when damaged, disturbed, or deteriorating. Information about asbestos is available at the Queensland Government Asbestos Website (asbestos.qld.gov.au) including common locations of asbestos and other practical guidance for homeowners.</p>

Part 5 – Rates and services

WARNING TO BUYER – The amount of charges imposed on you may be different to the amount imposed on the seller.

Rates

Whichever of the following applies—

The total amount payable* for all rates and charges (without any discount) for the property as stated in the most recent rate notice is:

Amount: Date Range:

OR

The property is currently a rates exempt lot.**

OR

The property is not rates exempt but no separate assessment of rates is issued by a local government for the property.

*Concessions: A local government may grant a concession for rates. The concession will not pass to you as buyer unless you meet the criteria in section 120 of the *Local Government Regulation 2012* or section 112 of the *City of Brisbane Regulation 2012*.

** An exemption for rates applies to particular entities. The exemption will not pass to you as buyer unless you meet the criteria in section 93 of the *Local Government Act 2009* or section 95 of the *City of Brisbane Act 2010*.

Water

Whichever of the following applies—

The total amount payable as charges for water services for the property as indicated in the most recent water services notice* is:

Amount: Date Range:

OR

There is no separate water services notice issued for the lot; however, an estimate of the total amount payable for water services is:

Amount: Date Range:

* A water services notices means a notice of water charges issued by a water service provider under the *Water Supply (Safety and Reliability) Act 2008*.

Part 6 – Community titles schemes and BUGTA schemes

(If the property is part of a community titles scheme or a BUGTA scheme this Part must be completed)

WARNING TO BUYER – If the property is part of a community titles scheme or a BUGTA scheme and you purchase the property, you will become a member of the body corporate for the scheme with the right to participate in significant decisions about the scheme and you will be required to pay contributions towards the body corporate’s expenses in managing the scheme. You will also be required to comply with the by-laws. By-laws will regulate your use of common property and the lot.

For more information about living in a body corporate and your rights and obligations, contact the Office of the Commissioner for Body Corporate and Community Management.

<p>Body Corporate and Community Management Act 1997</p>	<p>The property is included in a community titles scheme. (If Yes, complete the information below)</p>	<p><input type="checkbox"/> Yes <input type="checkbox"/> No</p>
<p>Community Management Statement</p>	<p>A copy of the most recent community management statement for the scheme as recorded under the <i>Land Title Act 1994</i> or another Act is given to the buyer.</p> <p>Note—If the property is part of a community titles scheme, the community management statement for the scheme contains important information about the rights and obligations of owners of lots in the scheme including matters such as lot entitlements, by-laws and exclusive use areas.</p>	<p><input type="checkbox"/> Yes</p>
<p>Body Corporate Certificate</p>	<p>A copy of a body corporate certificate for the lot under the <i>Body Corporate and Community Management Act 1997</i>, section 205(4) is given to the buyer.</p> <p>If No— An explanatory statement is given to the buyer that states:</p> <ul style="list-style-type: none"> » a copy of a body corporate certificate for the lot is not attached; and » the reasons under section 6 of the <i>Property Law Regulation 2024</i> why the seller has not been able to obtain a copy of the body corporate certificate for the lot. 	<p><input type="checkbox"/> Yes <input type="checkbox"/> No</p> <p><input type="checkbox"/> Yes</p>
<p>Statutory Warranties</p>	<p>Statutory Warranties—If you enter into a contract, you will have implied warranties under the <i>Body Corporate and Community Management Act 1997</i> relating to matters such as latent or patent defects in common property or body corporate assets; any actual, expected or contingent financial liabilities that are not part of the normal operating costs; and any circumstances in relation to the affairs of the body corporate that will materially prejudice you as owner of the property. There will be further disclosure about warranties in the contract.</p>	
<p>Building Units and Group Titles Act 1980</p>	<p>The property is included in a BUGTA scheme (If Yes, complete the information below)</p>	<p><input type="checkbox"/> Yes <input type="checkbox"/> No</p>
<p>Body Corporate Certificate</p>	<p>A copy of a body corporate certificate for the lot under the <i>Building Units and Group Titles Act 1980</i>, section 40AA(1) is given to the buyer.</p> <p>If No— An explanatory statement is given to the buyer that states:</p> <ul style="list-style-type: none"> » a copy of a body corporate certificate for the lot is not attached; and » the reasons under section 7 of the <i>Property Law Regulation 2024</i> why the seller has not been able to obtain a copy of the body corporate certificate for the lot. <p>Note—If the property is part of a BUGTA scheme, you will be subject to by-laws approved by the body corporate and other by-laws that regulate your use of the property and common property.</p>	<p><input type="checkbox"/> Yes <input type="checkbox"/> No</p> <p><input type="checkbox"/> Yes</p>

Signatures – SELLER



Signature of seller

Signature of seller

Robert Derek Morris

Name of Seller

Name of Seller

21/01/2026

Date

Date

Signatures – BUYER

By signing this disclosure statement the buyer acknowledges receipt of this disclosure statement before entering into a contract with the seller for the sale of the lot.

Signature of buyer

Signature of buyer

Name of buyer

Name of buyer

Date

Date

Queensland Titles Registry Pty Ltd
ABN 23 648 568 101

Title Reference:	13660213	Search Date:	07/01/2026 13:09
Date Title Created:	05/05/1964	Request No:	54634833
Previous Title:	13584110		

ESTATE AND LAND

Estate in Fee Simple

LOT 2 REGISTERED PLAN 100681
Local Government: BRISBANE CITY

REGISTERED OWNER

Dealing No: 710458430 28/03/2007
ROBERT DEREK MORRIS

EASEMENTS, ENCUMBRANCES AND INTERESTS

1. Rights and interests reserved to the Crown by
Deed of Grant No. 19510034 (POR 124)

ADMINISTRATIVE ADVICES

NIL

UNREGISTERED DEALINGS

NIL

** End of Current Title Search **

18900

Drawing of plan must be restricted

Calc. Bk. No. 209/157
Exd. 5/5/63
Passed 5/5/63

Street Name Vide letter 27/10/60 of 25/8/67

LYNELL
TOORAK

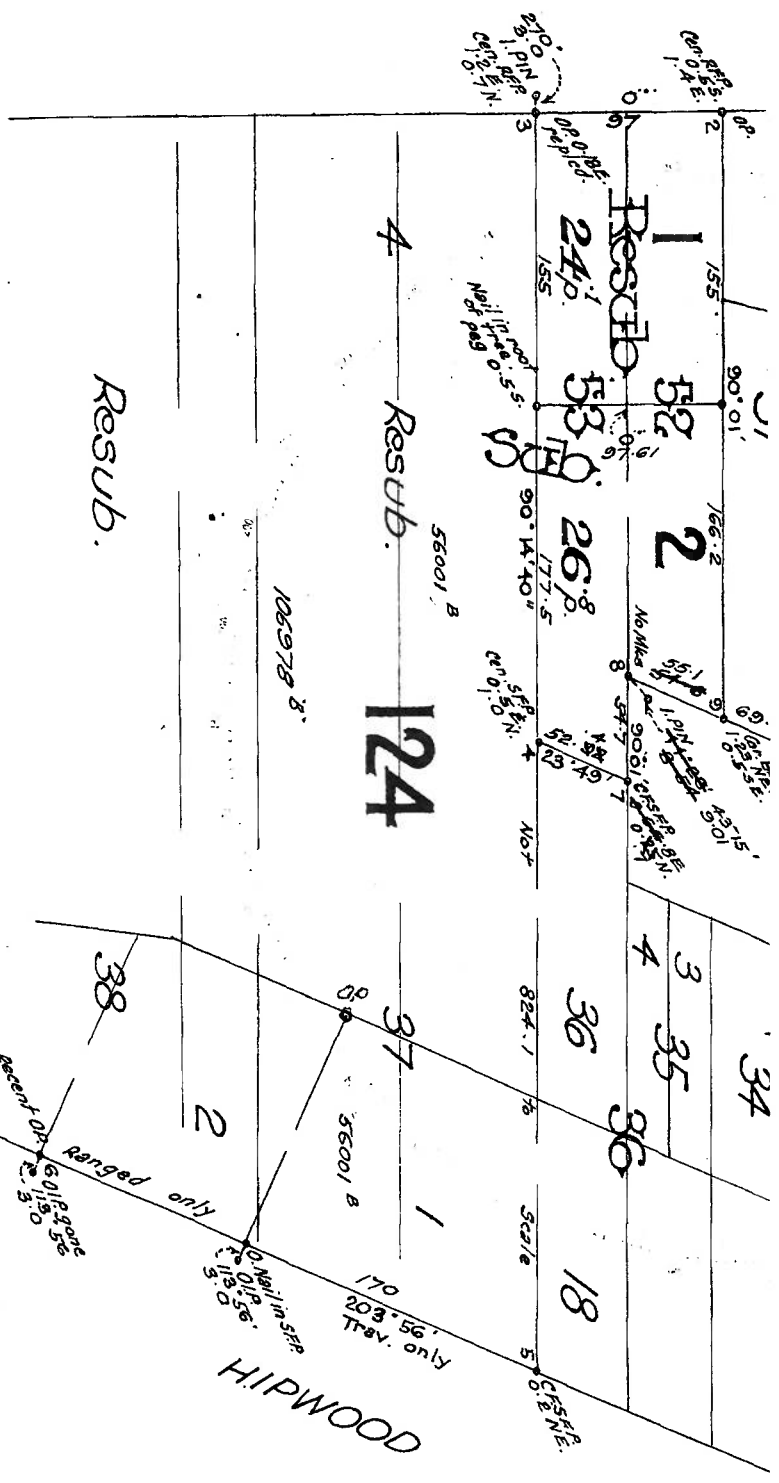

SCALE 80 Lks

182504-8

Common Seal of TOORAK INVESTMENT PTY LTD was hereunto affixed by the authority of a Resolution of the Board of Directors and in the presence of a Director of the said Company and the Secretary of the said Company in the presence of:



Particulars entered in Register Book.
Vol. 1801 Folio 37
the 18 day of June 1963 at 446 p.m.

Registrar of Titles
G. J. O'Brien



Directions in Red by me.
G. J. O'Brien
Municipal Surveyor
21/1/63

FOR LOT DESCRIPTION
SEE ABOVE

Corrections made 6/4/89 in accordance with Section 13 Land Title Act 1994.
see Dealing No. 703278032
Registrar of Titles
A. J. G. [Signature]
21/1/63



RE 122 of Subs. 52 & 53 of Resub.
36 of Sub. 3
124

CITY OF BRISBANE
Stamley
Toombury
Cat. No. 100681
CISP
899001

ed to the space inside the blue lines

B975434

1001137

B975434

For Additional Plan & Document Notings Refer to CISP

03248

2

H. MILLER, GARDNER

100681

C.A.

1100
1200
1100

1005
1005
1005

REC'D OF TITLES RECEIVED

1982 DEC 13 PM 1:22

MILLER

19292

23836

189001

This content was sent by email from Energex QLD in response to your Before You Dig enquiry.

Original subject Energex - BYDA Sequence No: 266326952 Job No: 52050921 - 2 MIKADO STREET,
HAMILTON
Original sender EnergyQLD@ticketaccess.pges.com.au
Received 07 Jan 2026 2:10:48pm AEDT

Assets found Before You Dig Australia (BYDA) Request

Please DO NOT SEND A REPLY to this email as it has been automatically generated and replies are not monitored.

The attached Plan details ENERGEX's Assets in relation to Your nominated search area.

Ensure You read and understand the important notes outlined below.

You:	BYDA Enquiry No:
Soft Reg	266326952
Company:	Date of Response:
Not Supplied	07 Jan 2026
Search Location:	Period of Plan Validity:
2 MIKADO STREET HAMILTON, QLD 4007	4 Weeks
External Comments (if any):	
61659 108113 [Contact:]	

WARNING: When working in the vicinity of Energex's Assets You have a legal Duty of Care that must be observed.

It is important that You note:

1. Immediately report life threatening emergencies to Emergency Services on **000** or to ENERGEX on **13 19 62**.
2. Please read and understand all the information and disclaimers provided - including the Terms and Conditions on the attached pages.
3. We have only searched the area which has been nominated in the request. If this nominated area is not what You require, please resubmit another enquiry with BYDA.
4. Plans provided by ENERGEX are only an indication of the presence of underground Assets within the nominated area. Locations provided are approximate and the plans are not suitable for scaling purposes, as exact ground cover and alignments cannot be provided. You must confirm the exact location of Assets by use of an electronic cable locator followed by careful, non-mechanical excavation (i.e. potholing).
5. Plans provided by ENERGEX do not encompass ENERGEX's overhead Assets.
6. ENERGEX, its servants or agents shall not be liable for any loss or damage caused or occasioned by the use of plans and details supplied pursuant to the BYDA Request and You agree to indemnify ENERGEX against any claim or demand for any such loss or damage to You, Your servants or Your agents.

For Emergency Situations
Please Call 13 19 62



BYDA

Sequence: 266326952
Date: 07/01/2026

Scale: 1:500
Title No: 1

- LEGEND**
- Substation
 - Cable Marker
 - Pole
 - Pillar
 - HV Cable (11kV - <33kV)
 - LV Cable (up to 1kV)
 - RT Boundary
 - Planned Work Area

AS5488 Category 'D' Plan

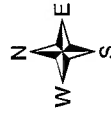

DISCLAIMER: While reasonable measures have been taken to ensure the accuracy of this plan, the Planner, Politecnico, and EnergeX nor Politecnico shall have any liability whatsoever in relation to any loss, damage, cost or expense arising from the use of this plan, or any information contained therein, or to the completeness or accuracy of such information. Use of such information is subject to and constitutes acceptance of these terms.

All underground cables shall be traced as being energized. Where a cable is located that is not represented on this ENERGEX BYDA map, then ENERGEX shall be contacted immediately.

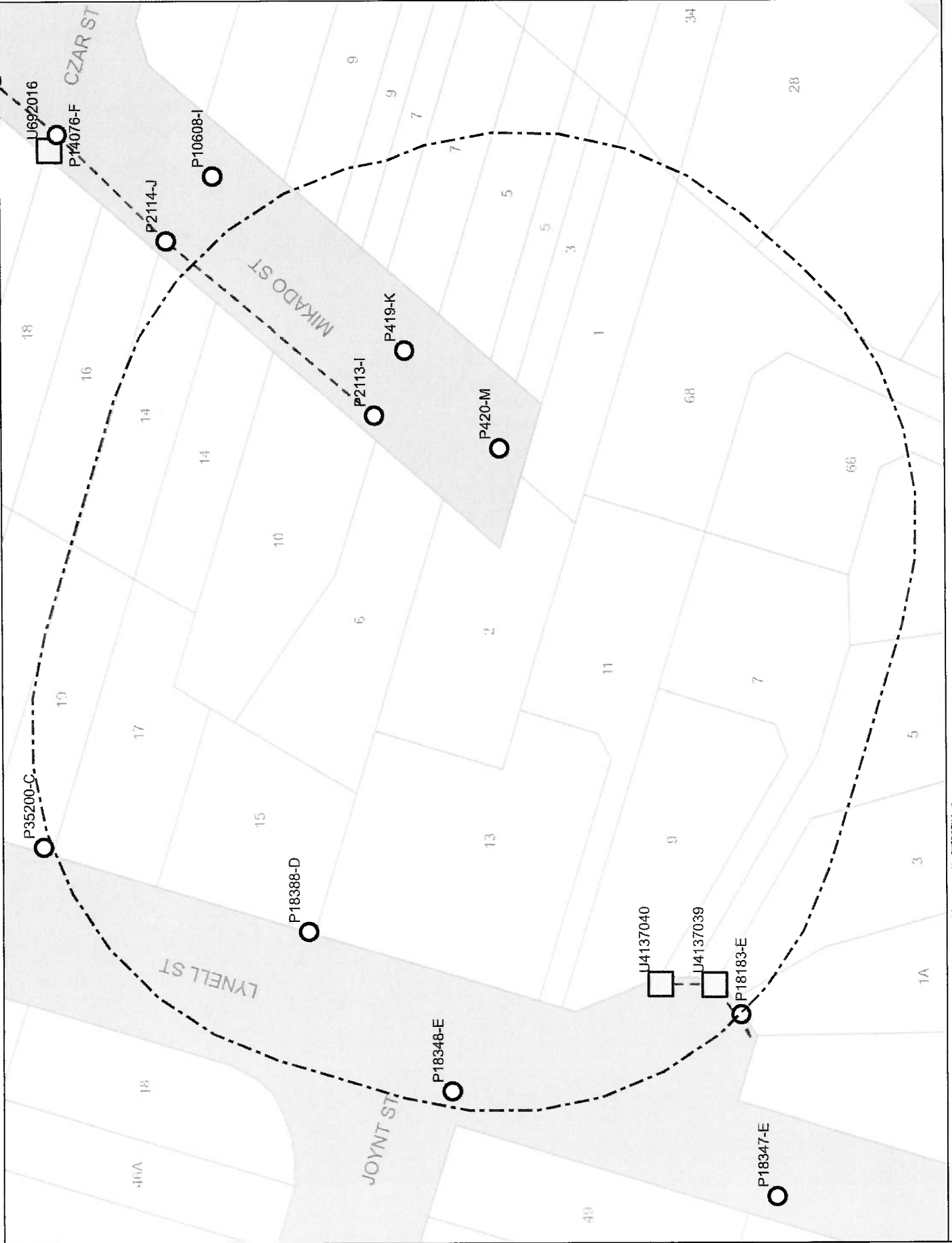

This output provides details of the ENERGEX electrical network. As a viewer, you accept no responsibility is incurred by ENERGEX for the accuracy or completeness of the information provided. Expectations of cables and electrical connectivity should be confirmed on site.

This content was sent by email from Queensland Urban Utilities in response to your Before You Dig enquiry.

Original subject BYDA Response for Job No 52050921, Sequence No 266326951
Original sender UrbanUtilities@ticketaccess.pces.com.au
Received 07 Jan 2026 2:11:20pm AEDT



UrbanUtilities

GPO Box 2765
Brisbane QLD 4001

Date: 07 Jan 2026

Before You Dig Australia Response

Please DO NOT SEND A REPLY to this email as it has been automatically generated and replies are not monitored.

Dear Soft Reg

We appreciate your diligence in contacting the Before You Dig Australia service (BYDA) prior to engaging in work or activities which may affect the water and sewerage infrastructure of Urban Utilities.

Job Number: 52050921
Sequence Number: 266326951
Enquiry Date: 7/01/2026 2:09:00 PM
Enquiry Location: 2 MIKADO STREET
 HAMILTON QLD 4007

WARNING: When working in the vicinity of Urban Utilities' assets you have a legal *Duty of Care* that must be observed.

Our records indicate the presence of infrastructure owned by Urban Utilities within your nominated search area, as shown on the attached plan.

Please note that you may be liable for any loss or damage to our infrastructure which is caused by any works or activities which you undertake over or near such infrastructure. Additionally, your works or activities may conflict with other works scheduled in your nominated search area. To avoid any unnecessary impacts, before any undertaking you must obtain the following approvals:

- And/or a Urban Utilities Network Access Permit for self assessable works or activities that are within two metres of our infrastructure (refer to [Urban Utilities Network Access Permit Webpage](#))
- Either a Build Over Asset (BOA) Approval for assessable building works undertaken within specified distances of our infrastructure (refer to [DHPW BOA Factsheet](#))

We have provided additional information about your responsibilities in relation to our infrastructure in the Important Information sheet attached to this letter. By accessing BYDA to obtain our records about our infrastructure, you warrant that you have read

Cable Plan

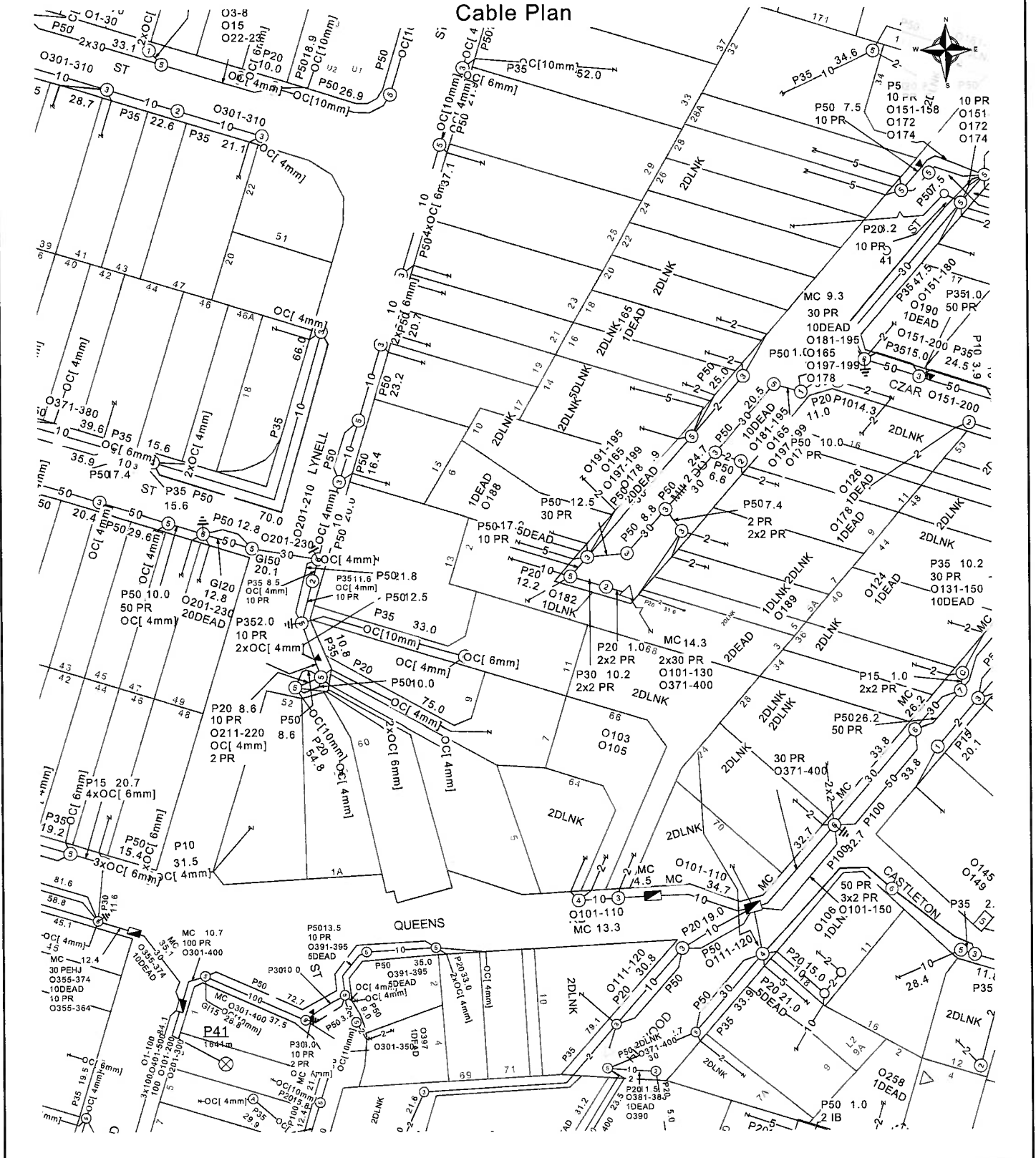

Report Damage: <https://service.telstra.com.au/customer-general/forms/report-damage-to-telstra>
 Ph - 13 22 03
 Email - Telstra.Plans@team.telstra.com
 Planned Services - ph 1800 653 935 (AEST bus hrs only) General Enquiries

TELSTRA LIMITED A.C.N. 086 174 781

Generated On 07/01/2026 14:12:00

Sequence Number: 266326954

CAUTION: Fibre optic and/ or major network present in plot area. Please read the Duty of Care and contact Telstra Plan Services should you require any assistance.

The above plan must be viewed in conjunction with the Mains Cable Plan on the following page

WARNING
 Telstra plans and location information conform to Quality Level "D" of the Australian Standard AS 5488-Classification of Subsurface Utility Information. As such, Telstra supplied location information is indicative only. Spatial accuracy is not applicable to Quality Level D. Refer to AS 5488 for further details. The exact position of Telstra assets can only be validated by physically exposing it. Telstra does not warrant or hold out that its plans are accurate and accepts no responsibility for any inaccuracy. Further on site investigation is required to validate the exact location of Telstra plant prior to commencing construction work. A Certified Locating Organisation is an essential part of the process to validate the exact location of Telstra assets and to ensure the asset is protected during construction works.

See the Steps- Telstra Duty of Care that was provided in the email response.

Mains Cable Plan

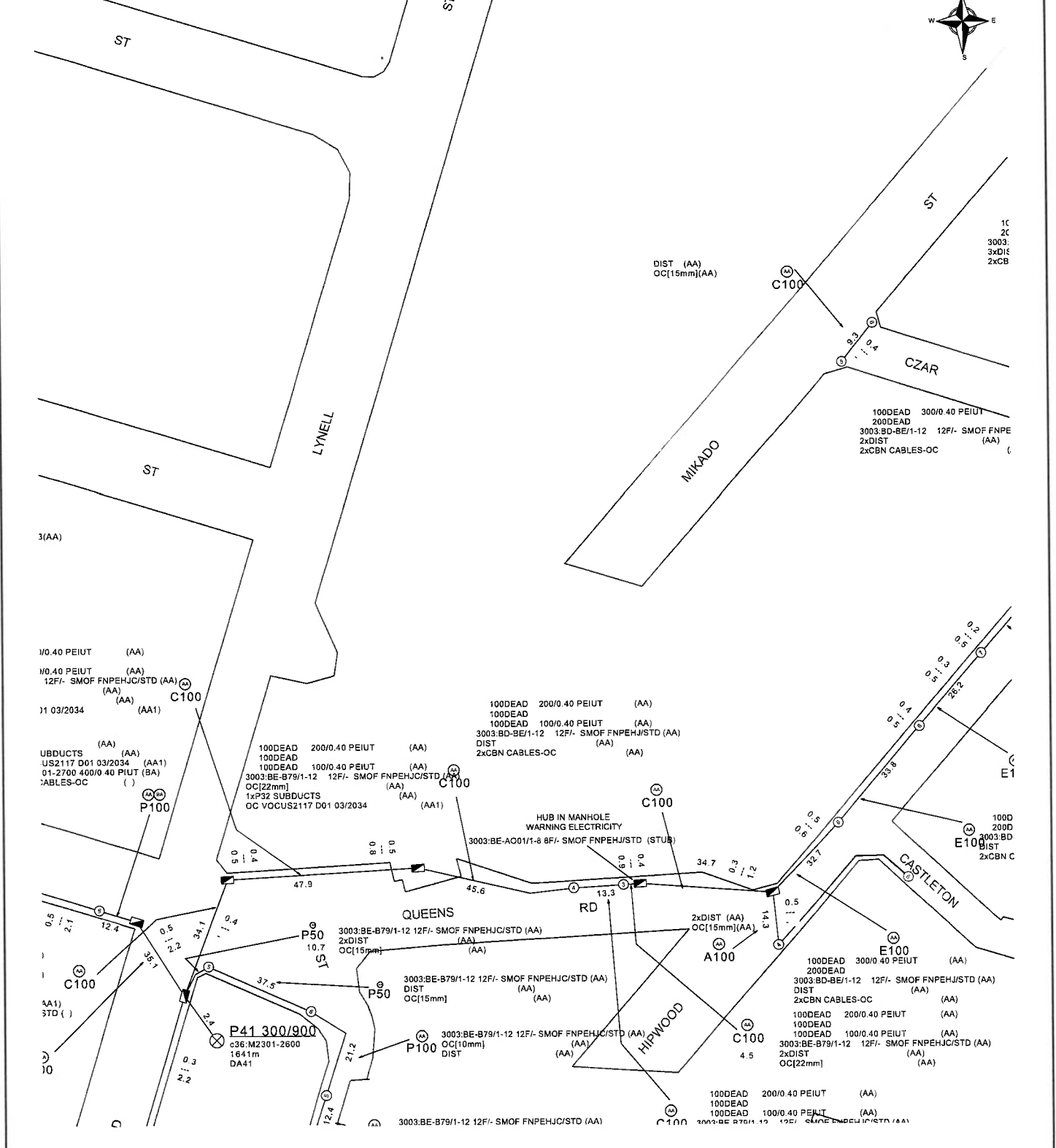

Report Damage: telstra@telstra.com.au or customer general forms report-damage-to-telstra-
 Ph - 13 22 03
 Email - Telstra.Plans@team.telstra.com
 Planned Services - ph 1800 653 935 (AEST bus hrs only) General Enquiries

Sequence Number: 266326954
CAUTION: Fibre optic and/ or major network present in plot area. Please read the Duty of Care and contact Telstra Plan Services should you require any assistance.

TELSTRA LIMITED A.C.N. 086 174 781
 Generated On 07/01/2026 14:12:07

The above plan must be viewed in conjunction with the Mains Cable Plan on the following page

WARNING
 Telstra plans and location information conform to Quality Level "D" of the Australian Standard AS 5488-Classification of Subsurface Utility Information. As such, Telstra supplied location information is indicative only. Spatial accuracy is not applicable to Quality Level D. Refer to AS 5488 for further details. The exact position of Telstra assets can only be validated by physically exposing it. Telstra does not warrant or hold out that its plans are accurate and accepts no responsibility for any inaccuracy. Further on site investigation is required to validate the exact location of Telstra plan prior to commencing construction work. A Certified Locating Organisation is an essential part of the process to validate the exact location of Telstra assets and to ensure the asset is protected during construction works.
 See the Steps- Telstra Duty of Care that was provided in the email response.

LEGEND



	Lead-in terminates at a Customer Address		Cable Jointing Pit Number / Letter indicating Pit type/size
	Exchange Major Cable Present		Elevated Joint (above ground joint on buried cable)
	Pillar / Cabinet Above ground Free Standing		Telstra Plant in shared Utility trench
	Above ground Complex Equipment Please note: Powered by 240v electricity		Aerial cable / or cable on wall
OC	Other Carrier Telecommunication Cable/ Asset. Not Telstra Owned		Aerial cable (attached to joint use Pole e.g., Power Pole)
DIST	Distribution cables in Main Cable Ducts		Marker Post installed
MC	Main Cable ducts on a Distribution Plan		Buried Transponder
	Blocked or Damaged Duct		Marker Post & Transponder
	Footway Access Chamber (can vary between 1-lid to 12-lid)		Optical Fibre Cable Direct Buried
	NBN Pillar		Direct Buried Cable
	Third Party Owned Network Non-Telstra		nbn owned network

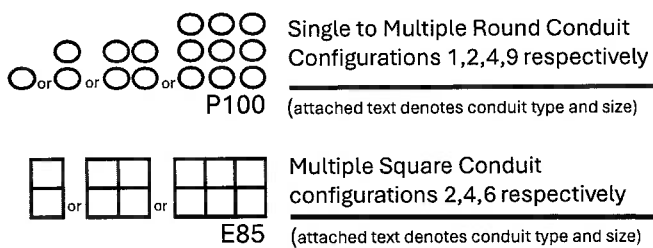

Some examples of conduit type and size:
 A - Asbestos cement, P - PVC / Plastic, C - Concrete, GI - Galvanised Iron, E - Earthenware
 Conduit sizes nominally range from 20mm to 100mm
 P50 50mm PVC conduit
 P100 100mm PVC conduit
 A100 100mm asbestos cement conduit

Some Examples of how to read Telstra Plans

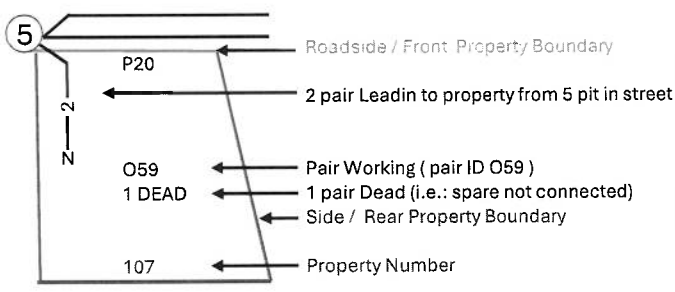
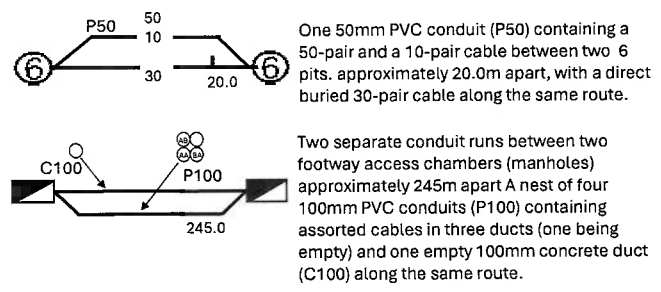

The 5 Ps of Safe Excavation

<https://www.byda.com.au/before-you-dig/best-practice-guides/>

Plan

Plan your job. Use the BYDA service at least one day before your job is due to begin, and ensure you have the correct plans and information required to carry out a safe project.

Prepare

Prepare by communicating with asset owners if you need assistance. Look for clues onsite. Engage a Certified Locator.

Pothole

Potholing is physically sighting the asset by hand digging or hydro vacuum extraction.

Protect

Protecting and supporting the exposed infrastructure is the responsibility of the excavator. Always erect safety barriers in areas of risk and enforce exclusion zones.

Proceed

Only proceed with your excavation work after planning, preparing, potholing (unless prohibited), and having protective measures in place.

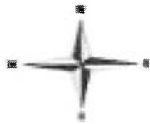

LEGEND

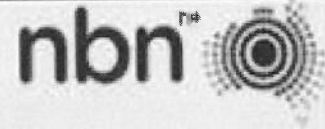

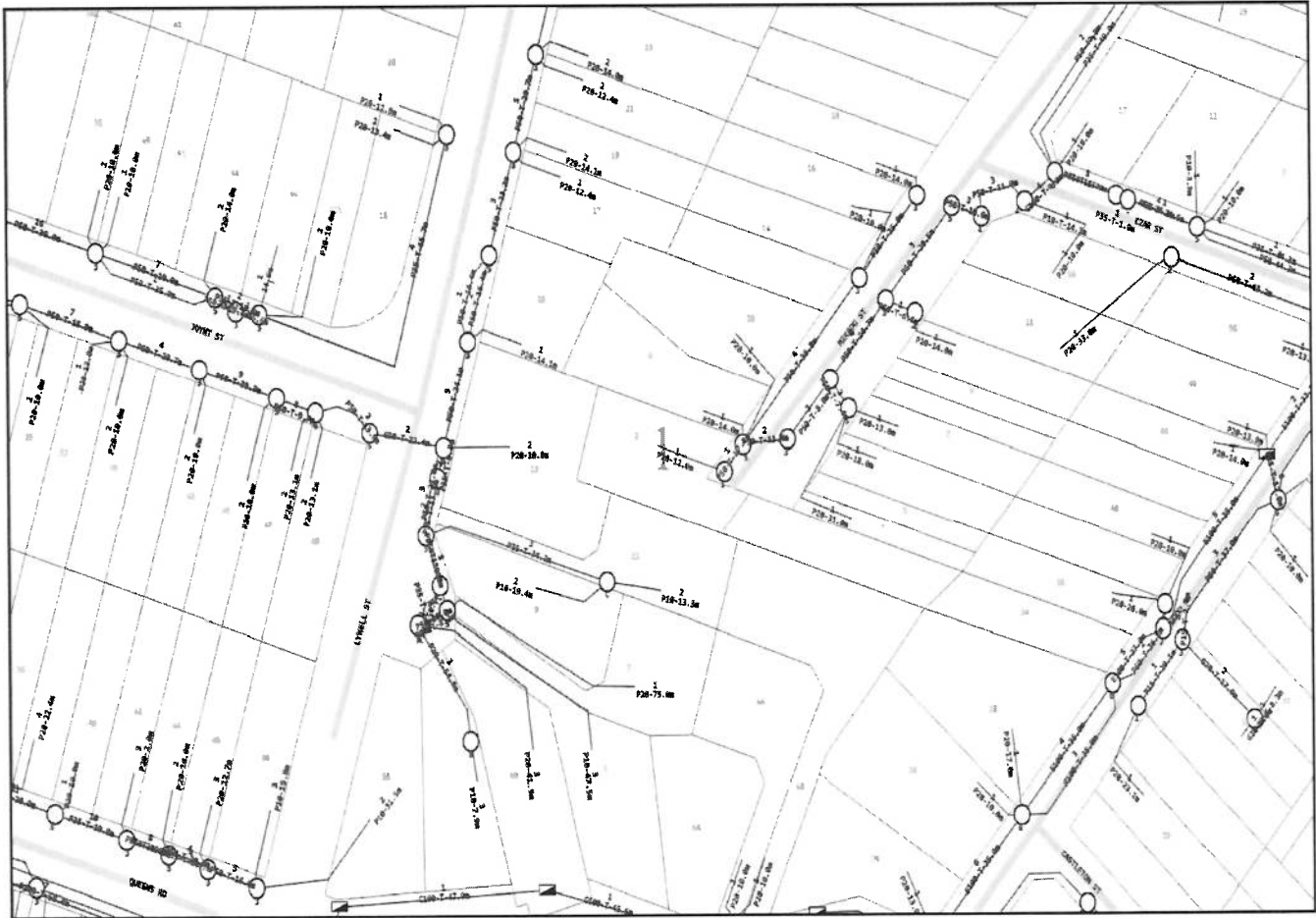

Emergency Contacts

You must immediately report any damage to the **nbn**™ network that you are/become aware of. Notification may be by telephone - 1800 626 329.

To: Soft Reg
Phone: Not Supplied
Fax: Not Supplied
Email: Soft.Reg.3576757@mail.au.pac.pcgcs.com.au

Before You Dig Australia Job #:	52050921	 BEFORE YOU DIG www.byda.com.au Zero Damage - Zero Harm
Sequence #	266326949	
Issue Date:	07/01/2026	
Location:	2 MIKADO STREET , HAMILTON , QLD , 4007	

Information

The area of interest requested by you contains one or more assets.

nbn™ Assets	Search Results
Communications	Asset identified
Electricity	No assets

In this notice **nbn™ Facilities** means *underground fibre optic, telecommunications and/or power facilities, including but not limited to cables, owned and controlled by nbn™*

Location of nbn™ Underground Assets

We thank you for your enquiry. In relation to your enquiry at the above address:

- **nbn's** records indicate that there **ARE nbn™** Facilities in the vicinity of the location identified above ("Location").
- **nbn** indicative plan/s are attached with this notice ("Indicative Plans").
- The Indicative Plan/s show general depth and alignment information only and are not an exact, scale or accurate depiction of the location, depth and alignment of **nbn™** Facilities shown on the Plan/s.
- In particular, the fact that the Indicative Plans show that a facility is installed in a straight line, or at uniform depth along its length cannot be relied upon as evidence that the facility is, in fact, installed in a straight line or at uniform depth.
- You should read the Indicative Plans in conjunction with this notice and in particular, the notes below.
- You should note that, at the present time, the Indicative Plans are likely to be more accurate in showing location of fibre optics and telecommunications cables than power cables. There may be a variation between the line depicted on the Indicative Plans and the location of any power cables. As such, consistent with the notes below, particular care must be taken by you to make your own enquiries and investigations to precisely locate any power cables and manage the risk arising from such cables accordingly.
- The information contained in the Indicative Plan/s is valid for 28 days from the date of issue set out above. You are expected to make your own inquiries and perform your own investigations (including engaging appropriately qualified plant locators, e.g BYDA Certified Locators, at your cost to locate **nbn™** Facilities during any activities you carry out on site).

We thank you for your enquiry and appreciate your continued use of the Before You Dig Australia Service. For any enquiries related to moving assets or Planning and Design activities, please visit the **nbn Commercial Works** website to complete the online application form. If you are planning to excavate and require further information, please email dbyd@nbnco.com.au or call 1800 626 329.

Notes:

1. You are now aware that there are **nbn™** Facilities in the vicinity of the above property that could be damaged as a result activities carried out (or proposed to be carried out) by you in the vicinity of the Location.
2. You should have regard to section 474.6 and 474.7 of the *Criminal Code Act 1995* (CoA) which deals with the consequences of interfering or tampering with a telecommunications facility. Only persons authorised by **nbn** can interact with **nbn's** network facilities.
3. Any information provided is valid only for **28 days** from the date of issue set out above.

Referral Conditions

The following are conditions on which **nbn** provides you with the Indicative Plans. By accepting the plans, you are agreeing to these conditions. These conditions are in addition, and not in replacement of, any duties and obligations you have under applicable law.

1. **nbn** does not accept any responsibility for any inaccuracies of its plans including the Indicative Plans. You are expected to make your own inquiries and perform your own investigations (including engaging appropriately qualified plant locators, e.g BYDA Certified Locators, at your cost to locate **nbn™** Facilities during any activities you carry out on site).
2. You acknowledge that **nbn** has specifically notified you above that the Indicative Plans are likely to be more accurate in showing location of fibre optics and telecommunications cables than power cables. There may be a variation between the line depicted on the Indicative Plans and the location of any power cables.
3. You should not assume that **nbn™** Facilities follow straight lines or are installed at uniformed depths



Job # 52050921
 Seq # 266326950
 Provider: Brisbane City Council
 Telephone: (07) 3403 8888

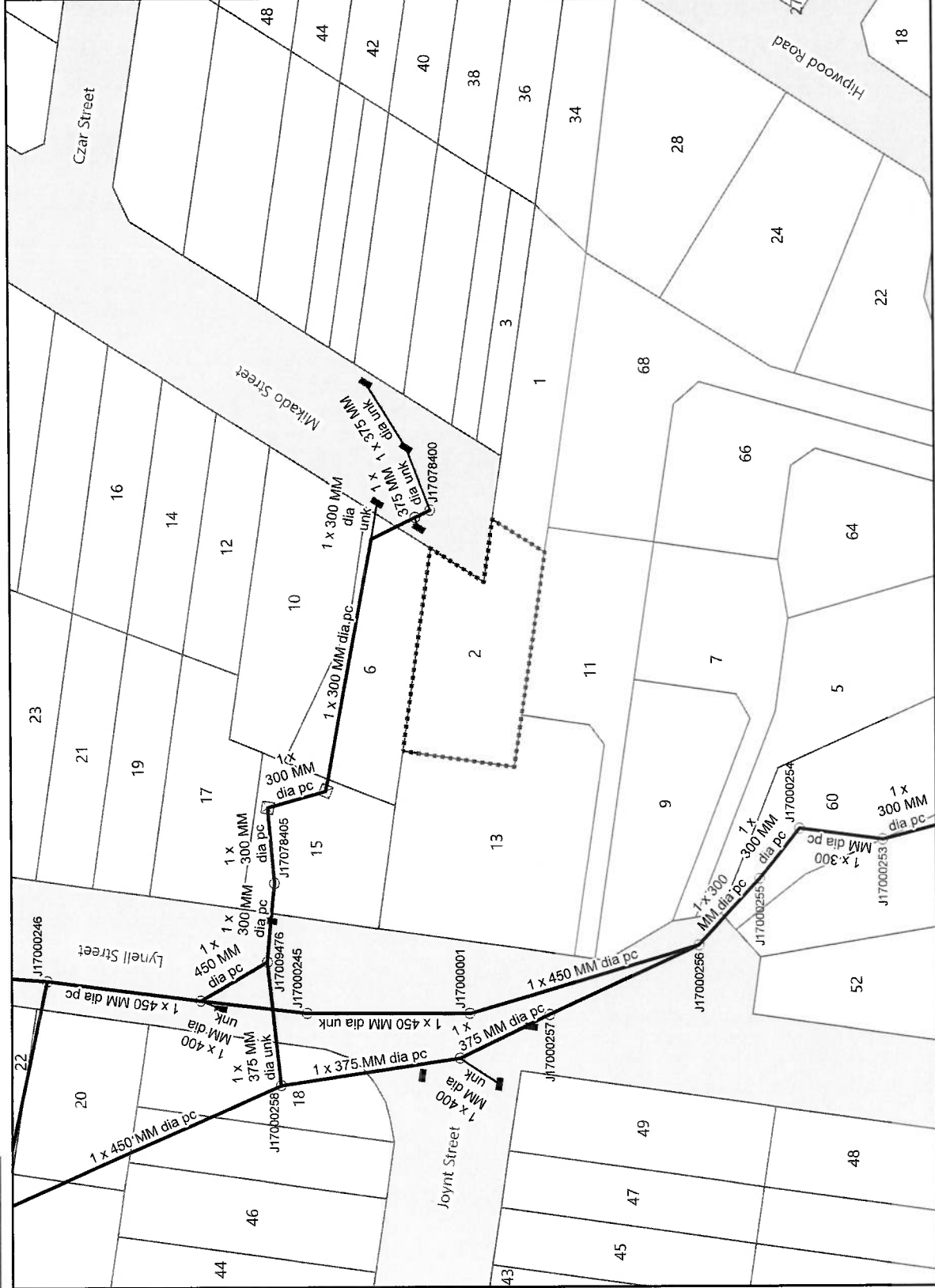

Legend

- BYDA Enquiry
- Stormwater Network
- Stormwater Drain
- Stormwater Gully / Roofwater Connection
- Stormwater Maintenance Hole
- Stormwater Gully Pit
- Stormwater Field Inlet

Disclaimer:
 © Brisbane City Council [2020]
 In consideration of Council, and the copyright owners listed below, permitting the use of this data, you acknowledge and agree that Council, and the copyright owners, give no warranty in relation to the data (including accuracy, reliability, completeness, currency or suitability) and accept no liability (including without limitation, liability in negligence) for any loss, damage or costs (including consequential damage), relating to any use of this data.
 Data must not be used for direct marketing or be used in breach of the privacy laws.
 Copyright of data is as follows:
 Cadastre and Street Names © 2020 State of Queensland (Department of Natural Resources, Mines and Energy)
 Caution: This map may contain the locations of abandoned underground asbestos pipes. Council gives no warranty to the completeness or accuracy of these records. Appropriate care needs to be taken in all cases.

Plans generated by
 SmarterWX™ Automate

Scale 1:1,000



In an emergency contact Brisbane City Council on 07 3403 8888
 07/01/26 (valid for 30 days)



**For your immediate information
THERE IS A GAS PIPELINE OR GAS ASSETS
located in close vicinity to your works.**

Enquiry Date: 07/01/2026
Enquirer: Soft Reg
Sequence Number: 266326953
Work Site Address: 2 MIKADO STREET
HAMILTON
QLD 4007

Thank you for your Before You Dig enquiry regarding the location of gas assets.

**We confirm there are Gas Assets located in close vicinity of the above location.
Caution: Damage to gas assets may result in explosion, fire and personal injury.**

Please ensure you read all the relevant information contained in this response to your BYDA enquiry including reviewing the **APA Guidelines for Works Near Existing Gas Assets** and clearly understand and comply with all requirements relating to your scope of work.

If you have any queries relating to this information, or you are unable to comply with requirements of the APA Guidelines for Works Near Existing Gas Assets contact the APA Before You Dig Officer

- Phone 1800 085 628
- Email BYDA_APA@apa.com.au

for clarification before proceeding with any work.

Site 2 MIKADO STREET
Address: HAMILTON
QLD 4007

Sequence 266326953
Number:

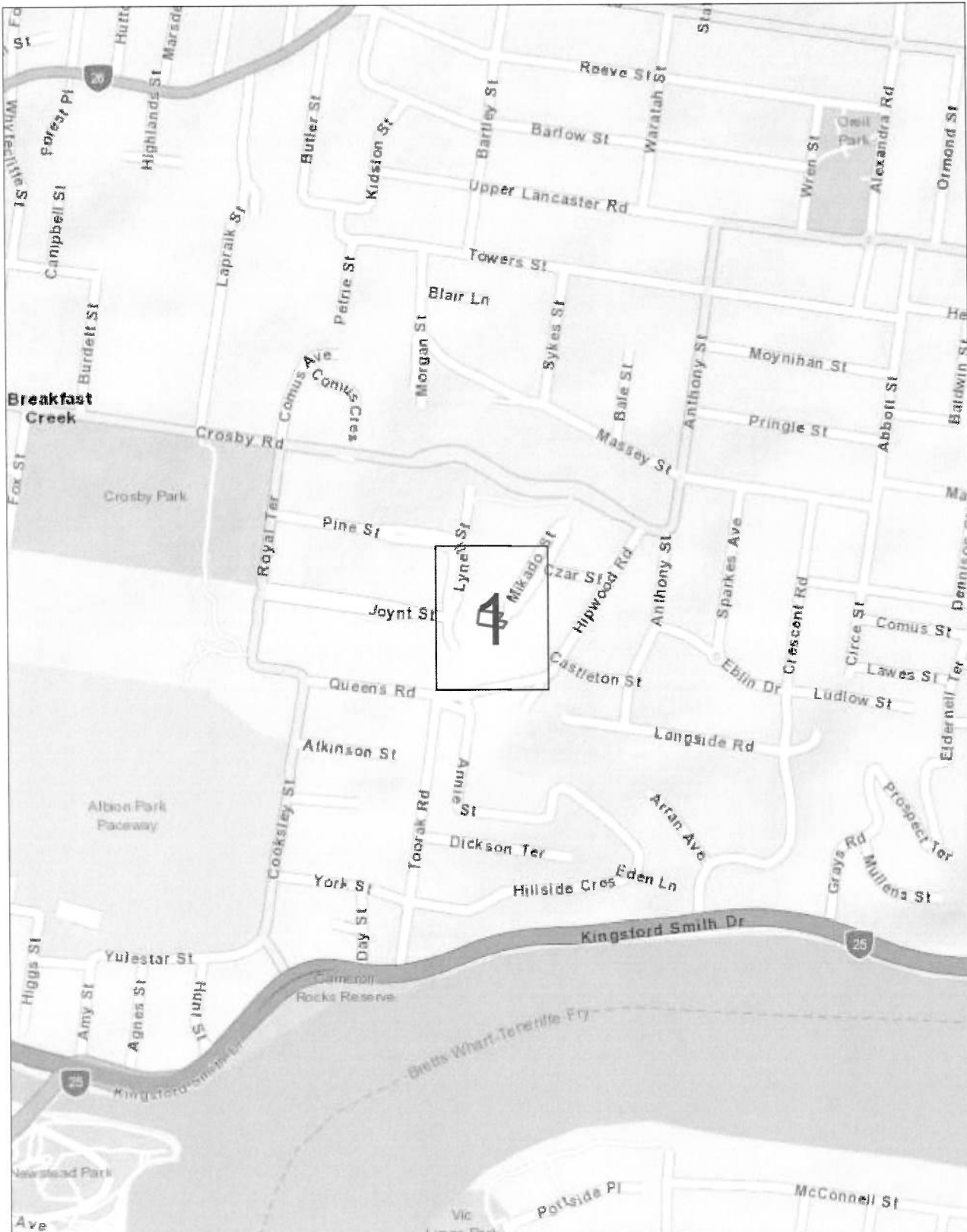

Scale 1: 6000

Map Sources: Esri, Garmin, HERE, FAO, NOAA, USGS,
© OpenStreetMap contributors, and the GIS User Community



Enquiry Area



Map Key Area



Legend

PIPE LEGEND: GAS TYPE AND PRESSURE

	Low pressure	Medium pressure	High pressure	Transmission
Natural gas				
Natural gas – proposed				
LPG (yellow dash)	<i>not applicable</i>			<i>not applicable</i>
Hydrogen blended (aqua dash)	<i>not applicable</i>			<i>not applicable</i>

PIPE LEGEND: SPECIAL DESIGNATION

	Low pressure	Medium pressure	High pressure	Transmission
Critical main (yellow highlight)				
Casing (grey highlight)				<i>not applicable</i>

These designations typically apply to any pipe type and pressure

PIPE LEGEND: OTHER STATUS

Abandoned pipe	
Idle or inactive pipe	

ABBREVIATION

BoK	Back of kerb	FoK	Front of kerb
C	Depth of cover	NTI	Not tied in
CP	Cathodic protection		

OBJECT SYMBOLS

Valve		CP test station		Syphon	
Buried valve		CP anode		Marker	
Regulator station		CP bond wire		Part service [^]	
Gas connected property		CP rectifier terminal		[^] A live gas service terminated underground within the property boundary, available for future extension to the gas meter.	

PIPE CODE AND MATERIAL

P*	Polyethylene (PE)	CU	Copper
P3	Polyvinyl chloride (PVC)	N2	Nylon
S*	Steel	W2	Wrought galv iron
C*	Cast iron	W3	PE coat wrought galv iron

INTERPRETATION EXAMPLE

	High pressure, 40 mm polyethylene in an 80 mm cast iron casing
	Medium pressure, 63 mm steel

Pipe diameter in millimetres is shown before pipe code.
40P6 = 40 mm nominal diameter

This map was created in colour and should be printed in colour

FORM 36 - NOTICE OF NO POOL SAFETY CERTIFICATE

EFFECTIVE OCTOBER 2022

Important information

1. Pool owners, including bodies corporate, are responsible for ensuring the barrier complies with the pool safety standard at all times, even after giving or receiving this Form 36.
2. Pool owners may be committing an offence by failing to comply with their pool safety obligations and penalties of up to 165 penalty units may be applied.
3. The owner must complete this form if a pool safety certificate is not in effect when:
 - selling a premises with a regulated pool; or
 - entering into an accommodation agreement (e.g. written, oral or implied agreement for provision of accommodation) for premises associated with a shared pool.
4. It is recommended the seller maintain a record of giving this form to the required parties.

For the seller:

When selling without a pool safety certificate, you need to fill out this Form 36. A Form 36 is completed as part of the contract of sale.

Before settlement you must give a copy to:

- the buyer; and
- the QBCC; and
- body corporate (if you are selling a home, unit or townhouse, where there is a shared pool).

For the buyer:

If you buy a property without a pool safety certificate you must get one within 90 days of settlement. The seller must have given you a Form 36 – notice of no pool safety certificate, before entering into a contract of sale.

For the lessor - non shared (private) pool:

You must get a pool safety certificate before a lease is signed for a house or townhouse with its own non-shared pool.

For the body corporate - shared pool:

The body corporate must also ensure a pool safety certificate is in effect within 90 days of settlement OR the date an accommodation agreement is entered into. A pool safety certificate must be displayed at the main entrance to the premises or at any gate or door giving access to the pool.

